

Directions to Title Resource Group Bishop's Gate Campus



From the New Jersey Turnpike -Northbound

Take Exit 4 -Mt. Laurel. After the toll booth, stay to the right, and take Route 73 North. Just past the traffic light is the entrance to I-295 North. Take I-295 North to exit 40A, Route 38 East. Stay in the right lane and Bishop's Gate is on your right almost immediately after you exit. Turn right into the entrance, and follow the drive until it comes to a "T." From there, make a left hand turn and SSG1 is the 2nd building on the left. Visitor parking is available to the right and left of the main entrance.

From I-295 Northbound

(From South Jersey/Delaware) Take exit 40A onto Route 38 East. Stay in right lane. Bishop's Gate will be on your right almost immediately after you exit. Turn right into the entrance, and follow the drive until it comes to a "T." From there make a left hand turn and SSG1 is the 2nd building on the left. Visitor parking is available to the right and left of the main entrance.

From I-295 Southbound

(From Trenton/Princeton) Take I-295 South to Exit 40, Route 38 West (Moorestown). Stay in the far right-hand lane after exiting, which is a "right turn only" lane that will take you to Marter Avenue. Turn left onto Marter, and stay in the left lane. Turn left at the light onto Route 38 East. (Basically, you have just made a U-turn to go East on Route 38.) The entrance to Bishop's Gate is approximately a quarter mile on the right, just past the I-295 interchange. Turn right into the entrance, and follow the drive until it comes to a "T." From there make a left hand turn and SSG1 is the 2nd building on the left. Visitor parking is available to the right and left of the main entrance.

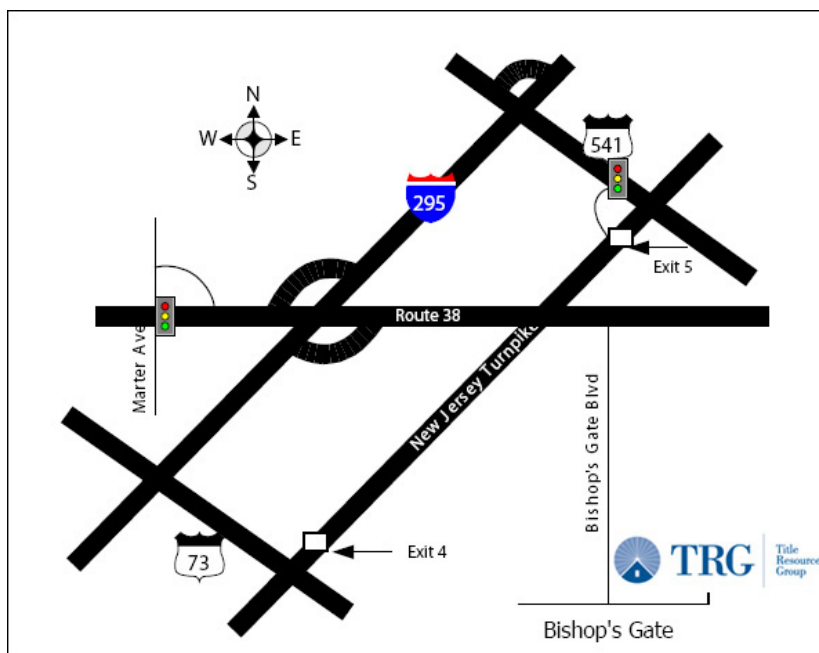

From Philadelphia International Airport

Take I-95 North to the Walt Whitman Bridge. Follow signs for I-295 North. Get off at exit 40A (Route 38 East). Stay in the right lane. The entrance to Bishop's Gate is on the right, almost immediately after you exit. Turn right into the entrance, and follow the drive until it comes to a "T." From there make a left hand turn and SSG1 is the 2nd building on the left. Visitor parking is available to the right and left of the main entrance.

From Center City Philadelphia

Take the Ben Franklin Bridge. After crossing the bridge, stay in one of the two left lanes and follow the signs to Route 38 East. Take Route 38 East approximately 10 miles. Bishop's Gate will be on your right almost immediately after you cross over the I-295 interchange. Turn right into the entrance, and follow the drive until it comes to a "T." From there make a left hand turn and SSG1 is the 2nd building on the left. Visitor parking is available to the right and left of the main entrance.

From New York

Take New Jersey Turnpike South to Exit 5 (Burlington-Mt. Holly Rt. 541). Make a left onto Rt. 541 West. Take Rt. 541 West to I-295 South. Take I-295 South to Exit 40, Route 38 West (Moorestown). Stay in the far right-hand lane after exiting, which is a "right turn only" lane that will take you to Marter Avenue. Turn left onto Marter, and stay in the left lane. Turn left at the light onto Route 38 East. (Basically, you have just made a U-turn to go East on Route 38.) The entrance to Bishop's Gate is approximately a quarter mile on the right, just past the I-295 interchange. Turn right into the entrance, and follow the drive until it comes to a "T." From there make a left hand turn and SSG1 is the 2nd building on the left. Visitor parking is available to the right and left of the main entrance.

Fax to: _____ From: _____

Fax No: _____ Dept: _____

Date: _____ Phone: _____